

MBT35AP Air Impact Press 8-1/2 Ton

High Impact, High Volume

With a 17,000-pound capability, the MBT35AP offers speed and consistency for jobs demanding high impact force with minimal exertion. Designed for use in indexing tables, transfer systems or assembly machines, the MBT35AP is ideal for embossing, shaping and serializing.

The adjustable impact force remains constant and is not altered by length of stroke, but by adjustment of spring compression. MB Metal Technologies offers a variety of springs for lighter or heavier marking, depending on the substrate to be marked.

MB Metal Technologies air impact models feature a variety of controls for enhanced safety.

With its clean, simple design and few operating components, the MBT35AP requires little maintenance. It adapts to a wide variety of impact jobs, using available tool inserts and marking heads. Units operate in any position and mount at either end using four tie rods with extended threads.



Applications Include:

- | | |
|-----------------|---------------|
| Marking | Numbering |
| Forming | Crimping |
| Peening | Embossing |
| Shaping | Piercing |
| Riveting | Press Fitting |
| Center Punching | Assembly |
| Stamping | Serializing |

MBT35AP Type Capacity Per Impact Press or Cylinder		
Height	Aluminum	Mild Steel
1mm	75	44
1.5mm	70	40
2mm	65	32
2.5mm	60	26
3mm	55	20
4mm	50	18
5mm	46	16
6mm	42	15

Specifications:

Max. Impact Force	8-1/2 Ton (17,000 lbs)
Std. Max. Approach Travel	55mm
Collet Diameter/Depth	16mm
Required Air Pressure	60-90 psi (4-6 bar)
Max. Strokes Per Minute	40
Unit Weight	300 lbs (136.07kg)

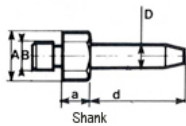
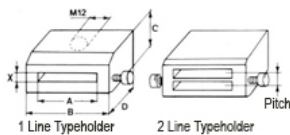

Type Set

- Downloads:**
- MV35AP Drawing.pdf
 - Replacement Parts.pdf
 - MV35AP Spec Sheet.pdf

CAD files are available upon request. Please [contact us](#) for details.



403 S Hawley Rd • Milwaukee, WI 53214-1997 • (800) 837-9270 • www.mbmataltech.com
© 2009 Mbmatal North America, LLC. All rights reserved.